

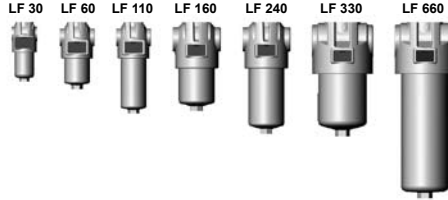

Inline Filter LF

up to 660 l/min, up to 100 bar



1. TECHNICAL SPECIFICATIONS

1.1 FILTER HOUSING

Construction

The filter housings are designed in accordance with international regulations. They consist of a filter head with screw-in filter bowl.

Standard equipment:

- port for clogging indicator in filter head
- mounting holes in the head
- pressure release/oil drain plug (LF 330 and above)

1.2 FILTER ELEMENTS

Hydac filter elements are validated and their quality is constantly monitored according to the following standards:

- ISO 2941
- ISO 2942
- ISO 2943
- ISO 3724
- ISO 3968
- ISO 11170
- ISO 16889

Contamination retention capacities in g

Betamicon® (BN4HC)

LF	3 µm	5 µm	10 µm	20 µm
30	4.6	5.1	5.4	5.6
60	6.5	7.3	7.8	8.0
110	13.8	15.5	16.4	16.9
160	19.8	22.2	23.5	24.3
240	32.3	36.3	38.4	39.6
330	47.2	53.1	56.1	57.9
660	102.2	114.9	121.5	125.4

Betamicon® (BH4HC)

LF	3 µm	5 µm	10 µm	20 µm
30	3.0	2.9	3.2	3.7
60	4.6	4.5	5.0	5.7
110	10.1	9.9	10.9	12.4
160	12.9	12.6	13.9	15.9
240	21.6	21.1	23.2	26.5
330	34.6	33.9	37.2	42.5
660	76.8	75.2	82.6	94.3

Filter elements are available with the following pressure stability values:

- Betamicon® (BN4HC): 20 bar
- Betamicon® (BH4HC): 210 bar
- Wire mesh (W): 20 bar
- Stainless steel fibre (V): 210 bar

1.3 FILTER SPECIFICATIONS

Nominal pressure	100 bar
Fatigue strength	at nominal pressure 10 ⁶ load cycles from 0 to nominal pressure (For other pressures, see graph at 1.8)
Temperature range	-30 °C to +100 °C (LF 660: -30 °C to -10 °C: p _{max} = 75 bar)
Material of filter head	Aluminium
Material of filter bowl	Aluminium (LF 660: steel)
Type of clogging indicator	VM (differential pressure indicator up to 210 bar operating pressure)
Setting pressure of clogging indicator	5 bar (others on request)
Bypass cracking pressure (optional)	6 bar (others on request)

1.4 SEALS

NBR (= Perbunan)

1.5 MOUNTING

As inline filter

1.6 SPECIAL MODELS AND ACCESSORIES

- bypass valve built into the head, separate from the main flow
- oil drain plug up to LF 240
- seals in FPM, EPDM
- test and approval certificates

1.7 SPARE PARTS

See Original Spare Parts List

1.8 FATIGUE STRENGTH

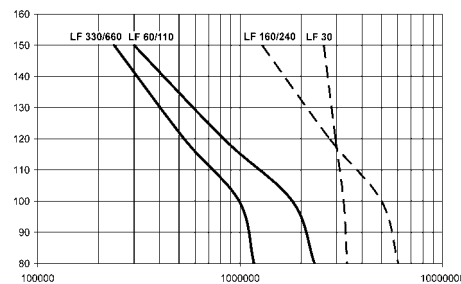

1.9 CERTIFICATES AND APPROVALS

On request

1.10 COMPATIBILITY WITH HYDRAULIC FLUIDS ISO 2943

- Hydraulic oils H to HLPD DIN 51524
- Lubrication oils DIN 51517, API, ACEA, DIN 51515, ISO 6743
- Compressor oils DIN 51506
- Biodegradable operating fluids VDMA 24568 HETG, HEES, HEPG
- Non-flam operating fluids HFA, HFB, HFC and HFD
- Operating fluids with high water content (>50% water content) on request

1.11 IMPORTANT INFORMATION

- Filter housing must be earthed
- When using electrical clogging indicators, the electrical power supply to the system must be switched off before removing the clogging indicator connector

Symbol for hydraulic systems

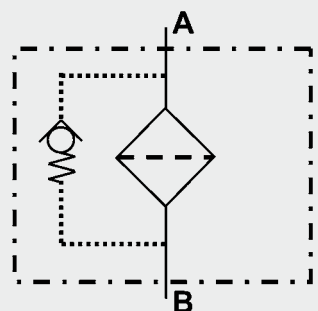

2. MODEL CODE (ALSO ORDER EXAMPLE)

LF BN/HC 60 I C 10 D 1 . X /-L24

2.1 COMPLETE FILTER

Filter type _____

LF

Filter material of element _____

BN/HC Betamicron® (BN4HC)
 BH/HC Betamicron® (BH4HC)
 W Stainless steel wire mesh
 V Stainless steel fibre

Size of filter or element _____

LF: 30, 60, 110, 160, 240, 330, 660

Operating pressure _____

I = 100 bar

Type and size of port _____

Port	Filter size						
	30	60	110	160	240	330	660
G ½	●						
G ¾		●	●				
G1 ¼				●	●		
G1 ½						●	●

Filtration rate in µm _____

BN4HC, BH4HC, V: 3, 5, 10, 20
 W: 25, 50, 100, 200

Type of clogging indicator _____

Y plastic blanking plug in indicator port
 A steel blanking plug in indicator port
 B visual
 C electrical
 D visual and electrical
 for other clogging indicators see brochure no. E 7.050.1...

Type code _____

1

Modification number _____

X the latest version is always supplied

Supplementary details _____

B. cracking pressure of bypass (e.g.: B6 = 6 bar); no details = without bypass valve
 L... light with appropriate voltage (24V, 48V, 110V, 220V)] only for clogging
 LED 2 light emitting diodes up to 24 Volt] indicators Type D
 SO 184 pressure release/oil drain plug (LF 330 series and above)
 V FPM seals
 W suitable for HFA and HFC emulsions
 (only required when using a clogging indicator, or V or W elements)

2.2 REPLACEMENT ELEMENT

0060 D 010 BN4HC /-V

Size _____

0030, 0060, 0110, 0160, 0240, 0330, 0660

Type _____

D

Filtration rate in µm _____

BN4HC, BH4HC, V: 003, 005, 010, 020
 W: 025, 050, 100, 200

Filter material _____

BN4HC, BH4HC, V, W

Supplementary details _____

V, W (for descriptions, see point 2.1)

2.3 REPLACEMENT CLOGGING INDICATOR

VM 5 D . X /-L24

Type _____

VM differential pressure indicator up to 210 bar operating pressure

Pressure setting _____

5 5 bar standard, others on request

Type of clogging indicator _____

D (see point 2.1)

Modification number _____

X the latest version is always supplied

Supplementary details _____

L..., LED, V, W (for descriptions, see point 2.1)

3. FILTER CALCULATION / SIZING

The total pressure drop of a filter at a certain flow rate Q is the sum of the housing Δp and element Δp and is calculated as follows:

$$\Delta p_{\text{total}} = \Delta p_{\text{housing}} + \Delta p_{\text{element}}$$

$$\Delta p_{\text{housing}} = (\text{see point 3.1})$$

$$\Delta p_{\text{element}} = Q \cdot \frac{SK^*}{1000} \cdot \frac{\text{viscosity}}{30}$$

(*see point 3.2)

For ease of calculation, our Filter Sizing Program is available on request free of charge.

NEW: Sizing online at www.hydac.com

3.1 Δp -Q HOUSING GRAPHS BASED ON ISO 3968

The housing graphs apply to mineral oil with a density of 0.86 kg/dm³ and a kinematic viscosity of 30 mm²/s. In this case, the differential pressure changes proportionally to the density.

LF 30

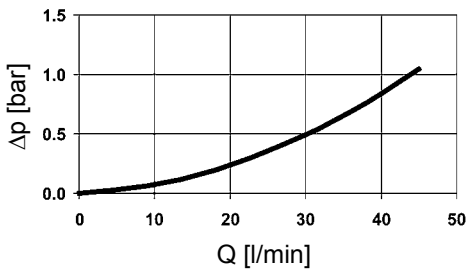

LF 60-110

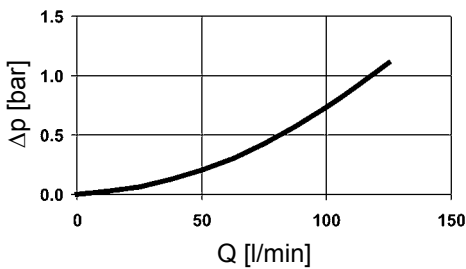

LF 160-240

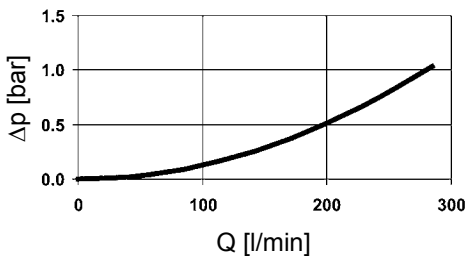

LF 330-660

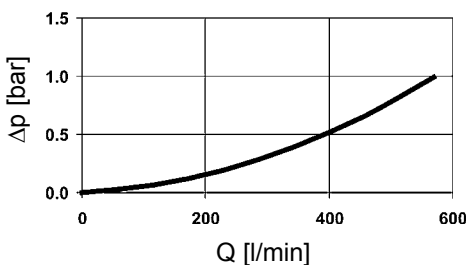

3.2 GRADIENT COEFFICIENTS (SK) FOR FILTER ELEMENTS

The gradient coefficients in mbar/(l/min) apply to mineral oils with a kinematic viscosity of 30 mm²/s. The pressure drop changes proportionally to the change in viscosity.

LF	V				W	BH4HC			
	3 μm	5 μm	10 μm	20 μm		-	3 μm	5 μm	10 μm
30	18.0	13.0	7.4	3.7	3.367	91.2	50.7	36.3	19.0
60	16.0	11.0	6.5	3.3	1.683	58.6	32.6	18.1	12.2
110	8.3	6.0	4.2	2.1	0.918	25.4	14.9	8.9	5.6
160	4.5	3.2	2.3	1.4	0.631	16.8	10.4	5.9	4.4
240	3.2	2.4	1.9	1.1	0.421	10.6	6.8	3.9	2.9
330	2.1	1.5	1.3	0.8	0.307	7.7	4.5	2.8	2.0
660	1.1	0.9	0.6	0.3	0.153	3.3	1.9	1.0	0.9

BN4HC: LF 30

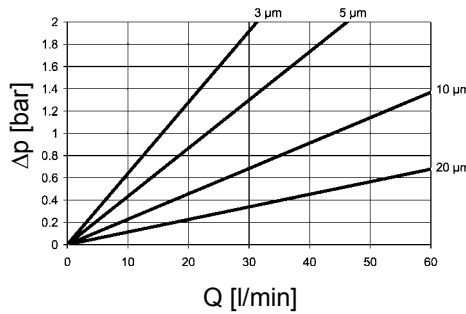

BN4HC: LF 60

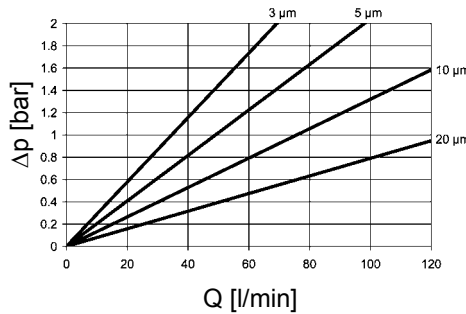

BN4HC: LF 110

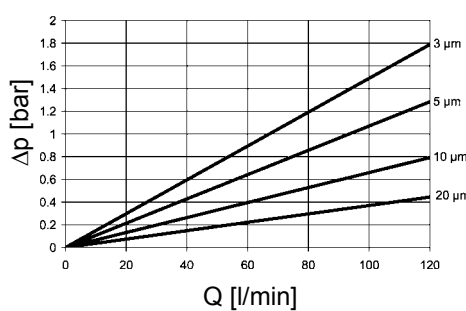

BN4HC: LF 160

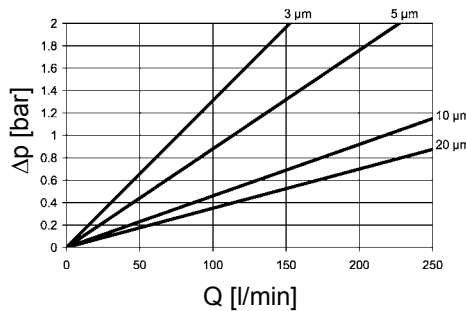

BN4HC: LF 240

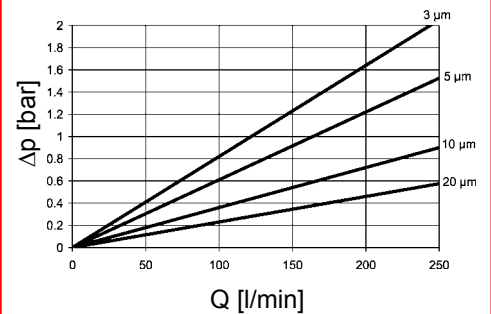

BN4HC: LF 330

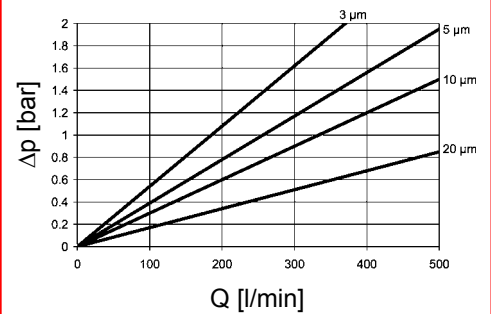

BN4HC: LF 660

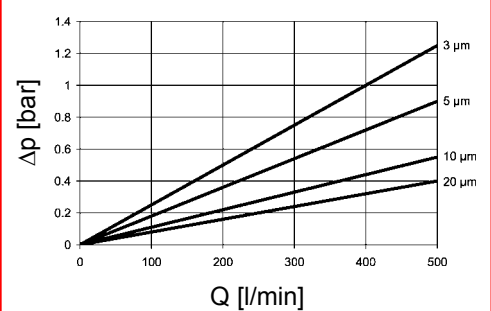

4. DIMENSIONS

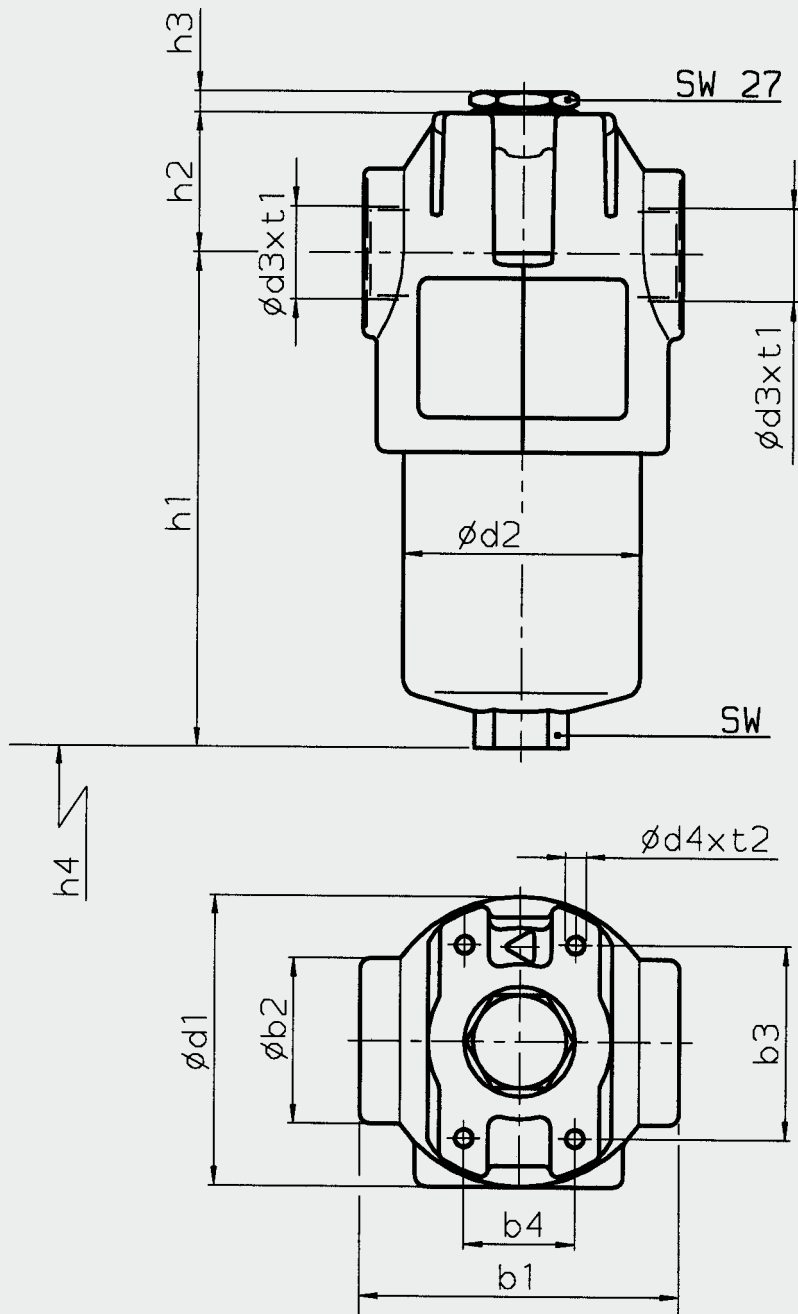

LF	b1	b2	b3	b4	d1	d2	d3	d4	h1	h2	h3	h4	SW	t1	t2	Weight including element [kg]	Volume of pressure chamber [l]
30	69	36	45	30	67	52	G $\frac{1}{2}$	M5	125.5	31	7	75	24	15	8	0.8	0.13
60	90	48	56	32	84	68	G $\frac{3}{4}$	M6	137.5	39	6	75	27	17	9	1.5	0.20
110	90	48	56	32	84	68	G $\frac{3}{4}$	M6	207.0	39	6	75	27	17	9	1.8	0.33
160	125	65	85	35	116	95	G1 $\frac{1}{4}$	M10	190.5	46	6	95	32	21	14	3.7	0.60
240	125	65	85	35	116	95	G1 $\frac{1}{4}$	M10	250.5	46	6	95	32	21	14	4.3	0.80
330	159	85	115	60	160	130	G1 $\frac{1}{2}$	M12	252.5	50	6	105	36	23	17	8.0	1.50
660	159	85	115	60	160	127	G1 $\frac{1}{2}$	M12	417.5	50	6	105	36	23	17	17.6	3.00

NOTE

The information in this brochure relates to the operating conditions and applications described.

For applications or operating conditions not described, please contact the relevant technical department.

Subject to technical modifications.

HYDAC Filtrertechnik GmbH
 Industriegebiet
D-66280 Sulzbach/Saar
 Tel.: 0 68 97 / 509-01
 Fax: 0 68 97 / 509-300
 Internet: www.hydac.com
 E-Mail: filter@hydac.com