

Ball valves KHB / KHM

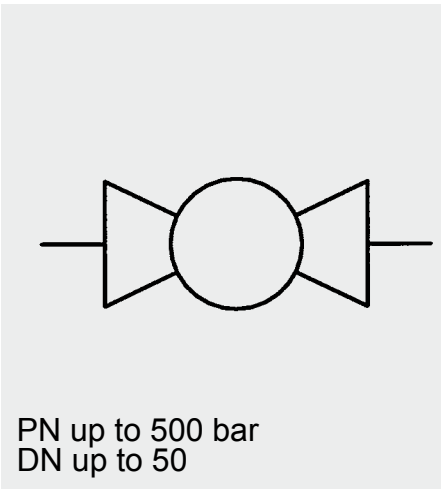

Model code
(also order example)

KHB G 1/2 1112 01 X .

Designation

KHB = Block-type ball valve DN 04-25
KHM = Sleeve-type ball valve DN 32-50

Type of connection

Thread size or
Outside diameter of pipe
and type of connection

Materials

Housing, connection adapters and control spindle

1 = Steel
3 = Stainless steel

Ball

1 = Steel
3 = Stainless steel

Ball seals

1 = POM
3 = PTFE
8 = Peek

Control spindle seal and connection seal

2 = NBR (Perbunan)
3 = PTFE
4 = FKM (Viton)

Handle

01 = Aluminium clamped handle, straight (AG) DN 12 - 50
02 = Aluminium clamped handle, cranked (AK) DN 12 - 50
03 = Zinc die-cast clamped handle, straight (ZG) DN 04 - 10, 13
04 = Zinc die-cast bolt-on handle, cranked (ZK) DN 04 - 10, 13
06 = Steel bolt-on handle, cranked (SK) DN 12 - 50
09 = Without handle

Series

(determined by manufacturer)

Surface protection

... = phosphate-plated (no details required)
A = zinc-plated, chrome (VI)-free

Delivery for non-standard valves is longer and the price is higher.

Technical specifications

Construction:	Block-type KHB DN 04 - 25 Sleeve-type KHM DN 32 - 50			
Types of connection:	Light and heavy threaded pipe connection to DIN 2353 Whitworth female thread to ISO 228 NPT SAE			
Mounting position:	Optional			
Ambient temperature:	-10 °C to +80 °C			
Nominal pressure:	up to PN 500 bar			
Operating fluids:	Mineral oil to DIN 51524 Part 1 and Part 2 (other fluids on request)			
Temperature of operating fluid:	-10 °C to +80 °C			
Type of construction:	Shut-off device is a ball			
Weight:	See table			
Flow direction:	Optional			
Spare parts:	Seal kits available on request			
Accessories:	All ball valves can be supplied with the following options: <table style="float: right; margin-left: 20px;"> <tr> <td>Actuator</td> </tr> <tr> <td>Limit controls</td> </tr> <tr> <td>Lock</td> </tr> </table>	Actuator	Limit controls	Lock
Actuator				
Limit controls				
Lock				

Hydraulic data

Nominal pressure	PN 315 bar up to PN 500 bar (see Table)
Operating fluids	Mineral oil to DIN 51524 Part 1 and Part 2 (other fluids on request)
Temperature of operating fluid	-10 °C to +80 °C

Dimensions

KHB

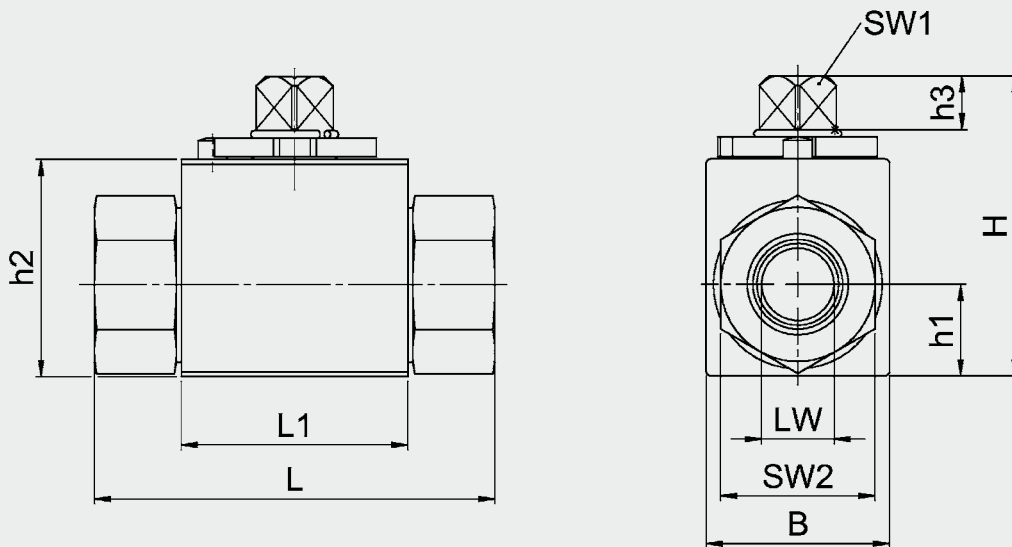

KHM

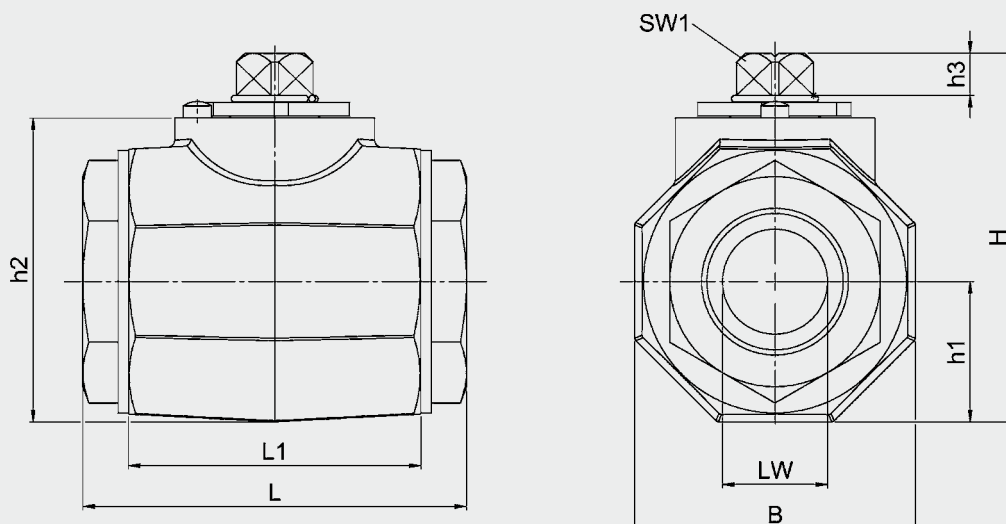

Steel

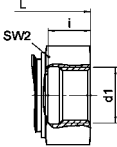
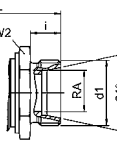
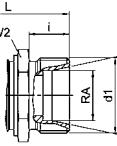
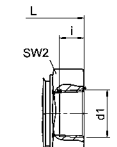
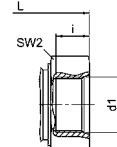
Connection type	Type	DN	LW	RA	d1	i	L	L1	B	H	h1	h2	h3	SW1	SW2	Wt. [kg]	Nom. press. PN [bar]
DIN ISO 228 Female thread 	KHB-G1/8	4	8	-	G1/8	10	69	37	26	44	13	32	7	9	22	0.29	500
	KHB-G1/4	6	8	-	G1/4	14	69	37	26	44	13	32	7	9	22	0.32	500
	KHB-G3/8	10	10	-	G3/8	14	72	42	32	53	17	40	8.5	9	27	0.46	500
	KHB-G1/2	13	12	-	G1/2	15	84	47	35	53	17	40	8.5	9	30	0.59	500
	KHB-G1/2	16	15	-	G1/2	16	83	47	38	62	19	45	11	12	32	0.7	400
	KHB-G3/4	20	20	-	G3/4	18	95	60	48	75	24.5	57	11.6	14	41	1.3	315
	KHB-G1	25	25	-	G1	20.5	113	65	57	82	28.5	64	11.6	14	50	2.03	315
	KHB-G11/4	25/32	25	-	G11/4	22	120	65	57	82	28.5	64	11.6	14	50		315
	KHM-G11/4	32	30	-	G11/4	22	109.4	83.4	80	105.2	40	86.7	12	17	60	3.1	315
	KHM-G11/2	40	38	-	G11/2	24	130	91	90	116.2	45	97.7	12	17	70	4.4	315
	KHM-G2	50	48	-	G2	28	140	100	111	134.2	55.5	115.7	12	17	80	6.6	315
DIN 2353 Light range 	KHB-06LR	4	4	6	M12x1.5	7	67	37	26	44	13	32	7	9	22	0.26	500
	KHB-08LR	6	6	8	M14x1.5	7	67	37	26	44	13	32	7	9	22	0.26	500
	KHB-10LR	8	8	10	M16x1.5	11	74	42	32	53	17	40	8.5	9	27	0.43	500
	KHB-12LR	10	10	12	M18x1.5	11	74	42	32	53	17	40	8.5	9	27	0.43	500
	KHB-15LR	13	12	15	M22x1.5	12	82	47	35	53	17	40	8.5	9	30	0.54	500
	KHB-15LR	12	12	15	M22x1.5	12	82	47	38	62	19	45	11.6	12	32	0.64	400
	KHB-18LR	13	12	18	M26x1.5	12	82	47	35	53	17	40	8.5	9	30	0.63	400
	KHB-18LR	16	15	18	M26x1.5	12	82	47	38	62	19	45	11	12	32	1.25	315
	KHB-22LR	20	19	22	M30x2	14	101	60	48	75	24.5	57	11.6	14	41	1.54	315
	KHB-28LR	25	24	28	M36x2	14	108	65	57	82	28.5	64	11.6	14	50	1.54	315
	KHB-35LR	25/32	25	35.3	M45x2	16	112	65	57	82	28.5	64	11.6	14	50		315
	KHM-35LR	32	30	35.3	M45x2	16	141.4	83.4	80	105.2	40	86.7	12	17	60	3.36	315
	KHM-42LR	40	36	42.3	M52x2	16	162	91	90	116.2	45	97.7	12	17	70	4.88	315
	DIN 2353 Heavy range 	KHB-08SR	4	5	8	M16x1.5	7	73	37	26	44	13	32	7	9	22	0.28
KHB-10SR		6	7	10	M18x1.5	7.5	73	37	26	44	13	32	7	9	22	0.32	500
KHB-12SR		8	8	12	M20x1.5	12	76	42	32	53	17	40	8.5	9	27	0.45	500
KHB-14SR		10	10	14	M22x1.5	14	80	42	32	53	17	40	8.5	9	27		500
KHB-16SR		13	12	16	M24x1.5	14	86	47	35	53	17	40	8.5	9	30	0.55	500
KHB-16SR		12	12	16	M24x1.5	14	86	47	38	62	19	45	11.6	12	32	0.65	400
KHB-20SR		13	12	20	M30x2	16	90	47	35	53	17	40	8.5	9	30	0.61	500
KHB-20SR		16	15	20	M30x2	16	90	47	38	62	19	45	11	12	32	0.67	400
KHB-25SR		20	20	25	M36x2	18	109	60	48	75	24.5	57	11.6	14	41	1.32	315
KHB-30SR		25	25	30	M42x2	20	120	65	57	82	28.5	64	11.6	14	50	1.87	315
KHB-38SR		25/32	25	38.3	M52x2	22	124	65	57	82	28.5	64	11.6	14	55		315
KHM-38SR		32	30	38.3	M52x2	22	153.4	83.4	80	105.2	40	86.7	12	17	60	3.43	315
ANSI B1.20.1 NPT female thread 		KHB-06NPT	6	8	-	1/4 - 18 NPT	6.7	69	37	26	44	13	32	7	9	22	0.3
	KHB-10NPT	10	10	-	3/8 - 18 NPT	10.36	72	42	32	53	17	40	8.5	9	27	0.5	500
	KHB-16NPT	13	12	-	1/2 - 14 NPT	13.56	84	47	35	53	17	40	8.5	9	30	0.6	500
	KHB-16NPT	16	15	-	1/2 - 14 NPT	13.56	83	47	38	62	19	45	11	12	32	0.75	400
	KHB-20NPT	20	20	-	3/4 - 14 NPT	13.86	95	60	48	75	24.5	57	11.6	14	41	1.3	350
	KHB-25NPT	25	25	-	1 - 11 1/2 NPT	17.34	113	65	57	82	28.5	64	11.6	14	50	2	350
	KHM-32NPT	32	30	-	1 1/4 - 11 1/2 NPT	17.95	109.4	83.4	80	105.2	40	86.7	12	17	60	3.1	350
	KHM-40NPT	40	38	-	1 1/2 - 11 1/2 NPT	18.38	130	91	90	116.2	45	97.7	12	17	70	4.4	350
	KHM-50NPT	50	48	-	2 - 11 1/2 NPT	19.22	140	100	111	134.2	55.5	115.7	12	17	80	6.6	350
	SAE J 5/4 UN/UNF Female thread 	KHB-06SAE	6	8	-	7/16 - 20 UNF	12	69	37	26	44	13	32	7	9	22	0.3
KHB-10SAE		10	10	-	9/16 - 18 UNF	13	72	42	32	53	17	40	8.5	9	27	0.5	500
KHB-16SAE		13	12	-	3/4 - 16 UNF	15	92	47	35	53	17	40	8.5	9	30	0.6	500
KHB-16SAE		16	15	-	3/4 - 16 UNF	15	83	47	38	62	19	45	11	12	32	0.75	400
KHB-20SAE		20	20	-	1 1/16 - 12 UN	20	95	60	48	75	24.5	57	11.6	14	41	1.3	350
KHB-25SAE		25	25	-	1 5/16 - 12 UN	20	113	65	57	82	28.5	64	11.6	14	50	2	350
KHM-32SAE		32	30	-	1 5/8 - 12 UN	20	109.4	83.4	80	105.2	40	86.7	12	17	60	3.1	350
KHM-40SAE		40	38	-	1 7/8 - 12 UN	20	130	91	90	116.2	45	97.7	12	17	70	4.4	350
KHM-50SAE		50	48	-	2 1/2 - 12 UN	20	140	100	111	134.2	55.5	115.7	12	17	80	6.6	350

Stainless steel

Connection type	Type	DN	LW	RA	d1	i	L	L1	B	H	h1	h2	h3	SW1	SW2	Wt. [kg]	Nom. press. PN [bar]
DIN ISO 228 Female thread	KHM-G1/8	4	8	-	G1/8	10	69	36	31	46.2	15.5	34.5	7	9	22	0.39	500
	KHM-G1/4	6	8	-	G1/4	14	69	36	31	46.2	15.5	34.5	7	9	22	0.39	500
	KHM-G3/8	10	10	-	G3/8	14	72	41	36	54	18	40.8	8.5	9	27	0.45	500
	KHM-G1/2	13	12	-	G1/2	16	84	41	36	54	18	40.8	8.5	9	30	0.53	500
	KHM-G1/2	16	15	-	G1/2	16	82.8	45.8	45	65.7	22.5	48.5	11	12	32	0.7	400
	KHM-G3/4	20	20	-	G3/4	18	95	58.3	55	77.8	27.5	60	11.6	14	41	1.64	315
	KHM-G1	25	25	-	G1	20.5	113	63.5	65	85.6	32.5	68	11.6	14	50	2.05	315
	KHM-G11/4	32	30	-	G11/4	22	109.4	83.4	80	105.2	40	86.7	12	17	60	3.29	315
	KHM-G11/2	40	38	-	G11/2	24	130	91	90	116.2	45	97.7	12	17	70	4	315
	KHM-G2	50	48	-	G2	28	140	100	111	134.2	55.5	115.7	12	17	80	6.82	315
DIN 2353 Light range	KHM-06LR	4	4	6	M12x1.5	10	67	36	31	46.2	15.5	34.5	7	9	22	0.38	500
	KHM-08LR	6	6	8	M14x1.5	10	67	36	31	46.2	15.5	34.5	7	9	22	0.38	500
	KHM-10LR	8	8	10	M16x1.5	11	74	41	36	54	18	40.8	8.5	9	27	0.62	500
	KHM-12LR	10	10	12	M18x1.5	11	74	41	36	54	18	40.8	8.5	9	27	0.62	500
	KHM-15LR	13	12	15	M22x1.5	12	82	41	36	54	18	40.8	8.5	9	30	0.74	500
	KHM-15LR	12	12	15	M22x1.5	12	81.8	45.8	45	65.7	22.5	48.5	11	12	32	0.64	400
	KHM-18LR	13	12	18	M26x1.5	12	82	41	36	54	18	40.8	8.5	9	30	0.95	400
	KHM-18LR	16	15	18	M26x1.5	12	81.8	45.8	45	65.7	22.5	48.5	11	12	32	0.65	315
	KHM-22LR	20	19	22	M30x2	14	101	58.3	55	77.8	27.5	60	11.6	14	41	1.74	315
	KHM-28LR	25	24	28	M36x2	14	108	63.5	65	85.6	32.5	68	11.6	14	50	2.75	315
DIN 2353 Heavy range	KHM-08SR	4	5	8	M16x1.5	12	73	36	31	46.2	15.5	34.5	7	9	22	0.39	500
	KHM-10SR	6	7	10	M18x1.5	12	73	36	31	46.2	15.5	34.5	7	9	22	0.39	500
	KHM-12SR	8	8	12	M20x1.5	12	76	41	36	54	18	40.8	8.5	9	27	0.62	500
	KHM-14SR	10	10	14	M22x1.5	14	80	41	36	54	18	40.8	8.5	9	27	0.64	500
	KHM-16SR	13	12	16	M24x1.5	14	86	41	36	54	18	40.8	8.5	9	30	0.77	500
	KHM-16SR	12	12	16	M24x1.5	14	85.8	45.8	45	65.7	22.5	48.5	11	12	32	0.66	400
	KHM-20SR	13	12	20	M30x2	16	90	41	36	54	18	40.8	8.5	9	32	0.87	500
	KHM-20SR	16	15	20	M30x2	16	89.8	45.8	45	65.7	22.5	48.5	11	12	32	0.69	400
	KHM-25SR	20	20	25	M36x2	18	109	58.3	55	77.8	27.5	60	11.6	14	41	1.85	315
	KHM-30SR	25	25	30	M42x2	20	120	63.5	65	85.6	32.5	68	11.6	14	50	2.96	315
KHM-38SR	32	30	38.3	M52x2	22	153.4	83.4	80	105.2	40	86.7	12	17	60	3.89	315	

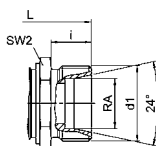
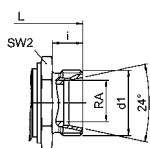
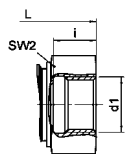

Dimensions of mounting bore

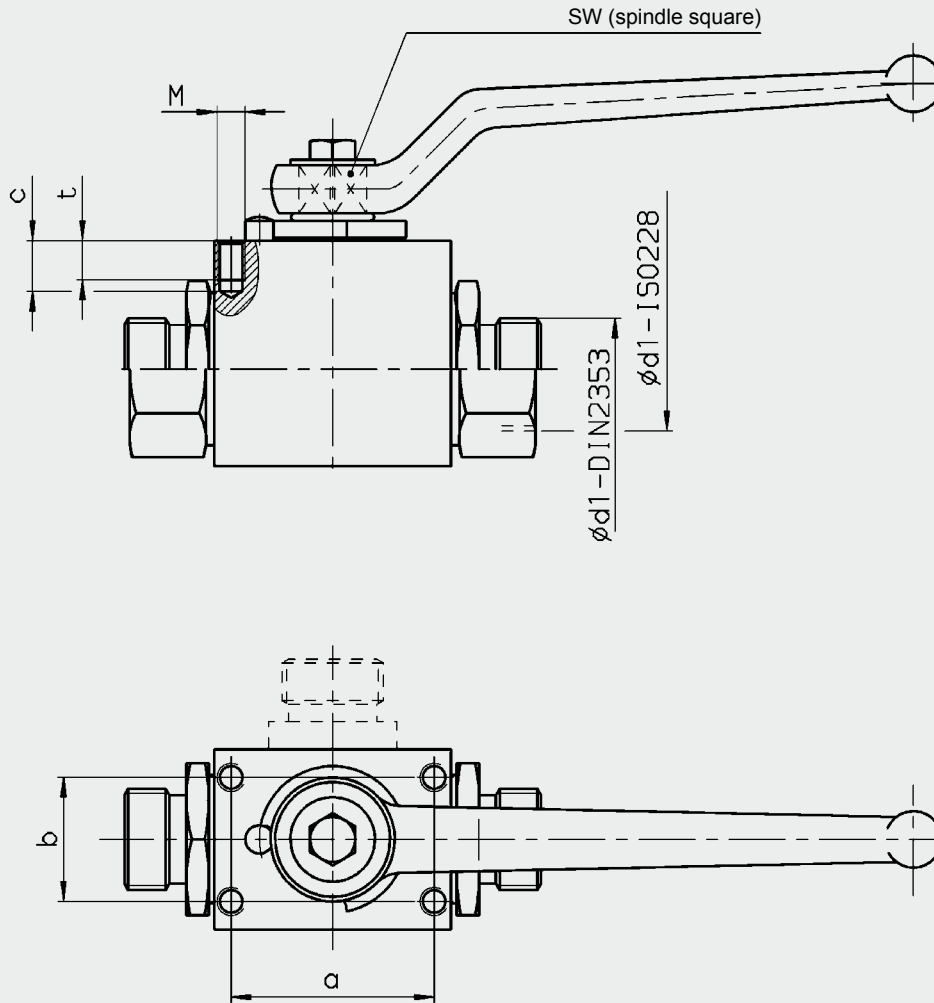

DIN ISO 228

Ød1	DN	SW	a	b	M	t	c
G 1/8	04	09	28	18	M4	6	8
G 1/4	06	09	28	18	M4	6	8
G 3/8	10	09	36	22	M5	7	9
G 1/2*	13	09	36	22	M5	7	9
G 1/2	16	12	36	22	M5	7	9
G 3/4	20	14	45	28	M6	9	11
G 1	25	14	45	28	M6	9	11

DIN 2353 Light Range

Ød1	DN	SW	a	b	M	t	c
06LR	04	09	28	18	M4	6	8
08LR	06	09	28	18	M4	6	8
10LR	08	09	36	22	M5	7	9
12LR	10	09	36	22	M5	7	9
15LR	12	12	36	22	M5	7	9
15LR*	13	09	36	22	M5	7	9
18LR	16	12	36	22	M5	7	9
18LR*	13	09	36	22	M5	7	9
22LR	20	14	45	28	M6	9	11
28LR	25	14	45	28	M6	9	11

DIN 2354 Heavy Range

Ød1	DN	SW	a	b	M	t	c
08SR	04	09	28	18	M4	6	8
10SR	06	09	28	18	M4	6	8
12SR	08	09	36	22	M5	7	9
14SR	10	09	36	22	M5	7	9
16SR	12	12	36	22	M5	7	9
16SR*	13	09	36	22	M5	7	9
20SR	16	12	36	22	M5	7	9
20SR*	13	09	36	22	M5	7	9
25SR	20	14	45	28	M6	9	11
30SR	25	14	45	28	M6	9	11

* reduced bore

Spare parts

(Seal kit)

KHB, DN 04 - 25

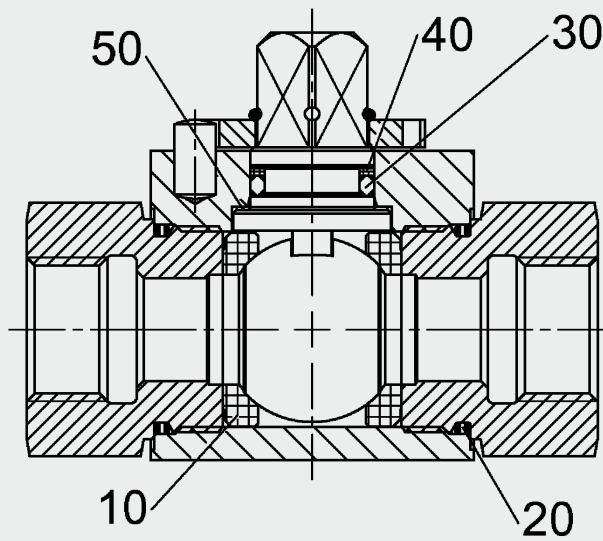

KHM, DN 32 - 50

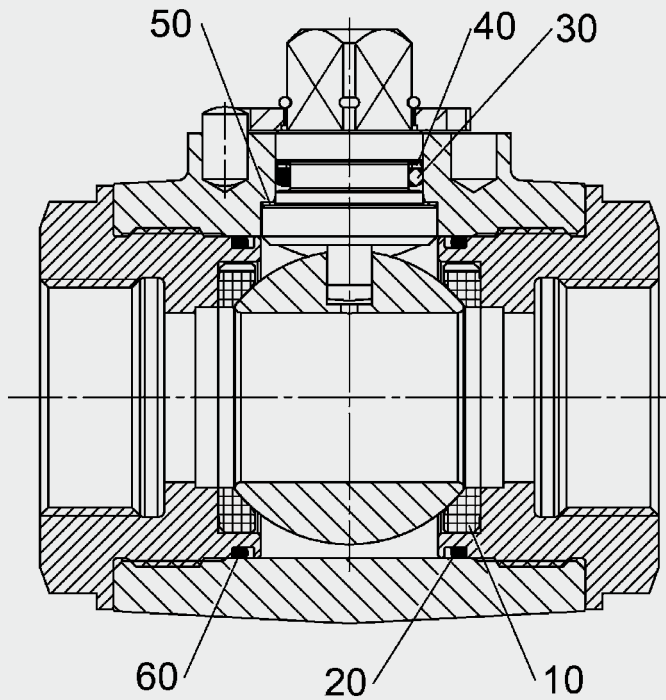

Seal kit	Order No. = Part No.
DN 04/06	703 048
DN 08/10	703 014
DN 13	703 046
DN 12/16	703 010
DN 20	703 005
DN 25	703 004
DN 32	703 045
DN 40	701 292
DN 50	703 007

The parts indicated by numbers in the above drawings are contained in the seal kit.

NOTE

The information in this brochure relates to the operating conditions and applications described.

For applications or operating conditions not described, please contact the relevant technical department.

Subject to technical modifications.

HYDAC Accessories GmbH
Hirschbachstr. 2
66280 Sulzbach/Saar
Tel.: +49 (0)6897 - 509-1001
Fax: +49 (0)6897 - 509-1009
Internet: www.hydac.com
E-Mail: info@hydac.com

Low Pressure Ball Valves KHNVN / KHNVS / KHN

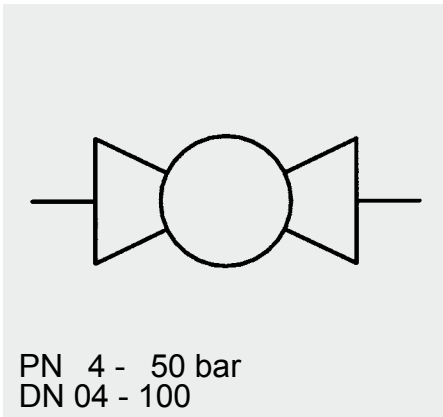

Model code

(also order example)

KHNVS Rp 1/2 2233 12 X ...

Designation

KHNVN – Low pressure ball valve – standard model
 KHNVS – Low pressure ball valve – heavy-duty model
 KHN – Low pressure ball valve – DIN-DVGW
 (German Technical Association for Gas & Water)

Connection type

Thread Size

Materials

Housing, control spindle
 2 = brass, nickel-plated

Ball
 2 = brass, chrome-plated

Ball seals
 3 = PTFE

Soft seals
 2 = NBR (Perbunan)
 3 = PTFE

Handle

12 = aluminium handle, cranked, supplied fitted

Series

(determined by manufacturer)

Approval

DIN-DVGW (KHN only)

Dimensions

KHNVN / KHNVS

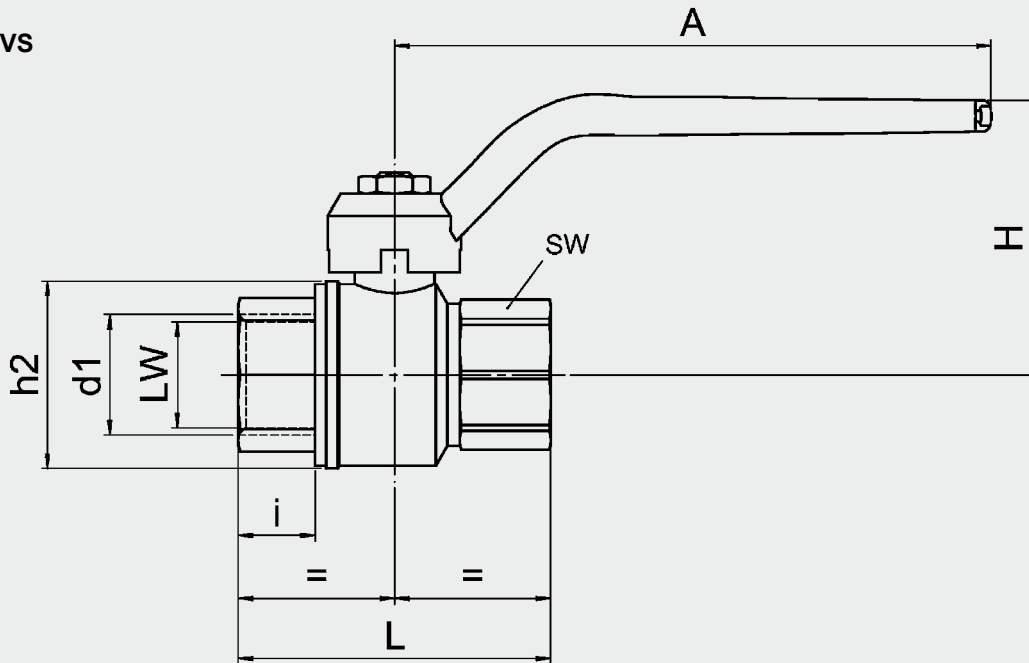

Type	d1	L [mm]	h2 [mm]	H [mm]	A [mm]	i [mm]	LW [mm]	SW [mm]	Nom. pressure PN [bar]
KHNVN	G 1/4	44.4	23.5	37	80	10	10	18	50
KHNVN	G 3/8	44.4	24	37	80	10	10	21	50
KHNVN	G 1/2	50.5	30.5	41	80	12	15	25	50
KHNVN	G 3/4	57.5	37.0	55	113	12.5	20	31	40
KHNVN	G 1	70	45.5	59	113	15	25	38	40
KHNVN	G 1 1/4	80.5	57	74.5	137.5	17	32	47	30
KHNVN	G 1 1/2	94	70	80.5	137.5	18.5	40	54	30
KHNVN	G 2	112.5	84	96.5	157	22	50	66	25
KHNVN	G 2 1/2	134.5	109	116	197	24	65	85	18
KHNVN	G 3	157	131	133	250	26	80	99	16
KHNVN	G 4	190	164	148	250	30	100	125	14

Type	d1	L [mm]	h2 [mm]	H [mm]	A [mm]	i [mm]	LW [mm]	SW [mm]	Nominal pressure PN [bar]
KHNVS	Rp 1/4	49.5	23.5	37	80	11	10	18	50
KHNVS	Rp 3/8	52.4	24	37	80	11.4	10	21	50
KHNVS	Rp 1/2	61	30.5	48.3	88.5	15	15	25	50
KHNVS	Rp 3/4	68	37	54.8	113	16.3	20	31	40
KHNVS	Rp 1	85	45.5	58.8	113	19.1	25	38	40
KHNVS	Rp 1 1/4	99.5	58	75	137.5	21.4	32	47	30
KHNVS	Rp 1 1/2	109	71	90	157.3	21.4	40	54	30
KHNVS	Rp 2	130	85	97	157.3	25.7	50	66	25

Technical specifications

Type of connection:	Whitworth female thread to ISO 228 (G) Whitworth female thread to DIN 2999 (Rp)
Mounting position:	Optional
Ambient temperature:	-20 °C to + 160 °C
Nominal pressure:	up to PN 50 bar
Operating media:	Mineral oil to DIN 51524 Part 1 + 2, gaseous media, compressed air, water other media on request
Temperature of operating media:	-20 °C to + 160 °C
Accessories:	All ball valves can be supplied with the following options: Actuator Limit controls Lock

KHN - DVGW

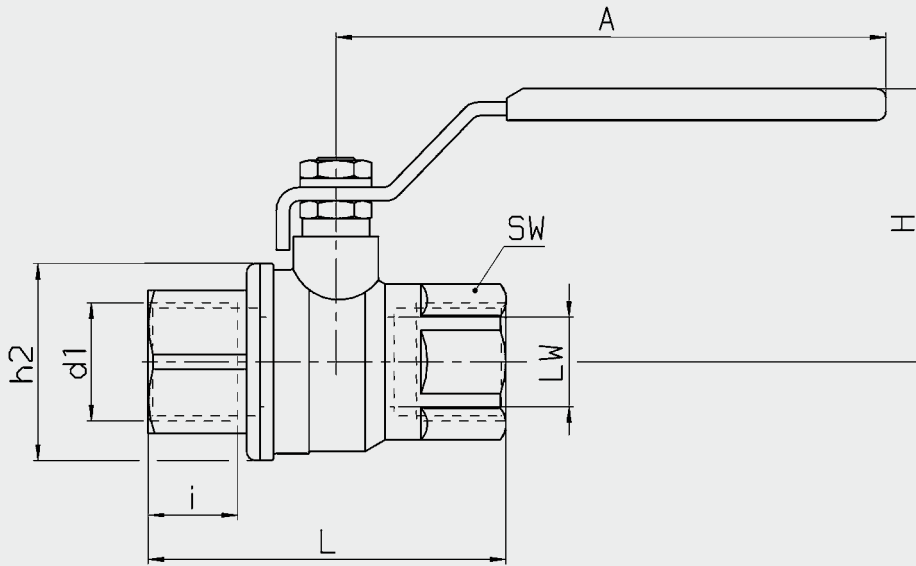

Type DVGW	d1	Nom. bore DN	ØLW	Nom. press. PN [bar]	i	L	Øh2	H	A	SW	Weight [kg]
KHN	Rp1/4	06	8	4	11.4	51.5	23	48	95	20	0.14
KHN	Rp3/8	10	10	4	11.4	51.5	23	48	95	20	0.13
KHN	Rp1/2	16	15	4	15.0	62	32	51	95	25	0.21
KHN	Rp3/4	20	20	4	16.3	69	39	60	110	31	0.33
KHN	Rp1	25	25	4	19.1	83	49	64	110	38	0.53
KHN	Rp1 1/4	32	32	4	21.4	96	59	78	160	48	0.97
KHN	Rp1 1/2	40	40	4	21.4	108	73	86	160	54	1.45
KHN	Rp2	50	50	4	25.7	126	86	104	170	67	1.98

Technical specifications

Type of connection:	Whitworth female thread to ISO 7/1 (Rp)
Mounting position:	Optional
Certification:	<u>DIN</u> -DVGW (EN 331)
Ambient temperature:	-10 °C to + 70 °C
Nominal pressure:	PN 4 bar
Operating media:	all gases in accordance with DVGW – Worksheet G260/I
Temp. of operating media:	5 °C to + 50 °C

NOTE

The information in this brochure relates to the operating conditions and applications described.

For applications or operating conditions not described, please contact the relevant technical department.

Subject to technical modifications.

HYDAC Accessories GmbH
Hirschbachstr. 2
66280 Sulzbach/Saar
Tel.: +49 (0)6897 - 509-1001
Fax: +49 (0)6897 - 509-1009
Internet: www.hydac.com
E-Mail: info@hydac.com



Stainless Steel Low Pressure Ball Valves

KHNVN / KHNVS

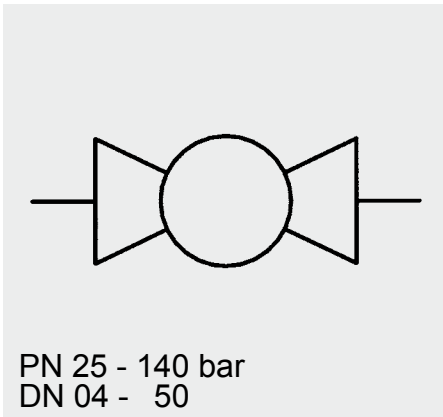

Model code

(also order example)

KHNVS Rp 1/2 3333 18 X

Designation

KHNVN – Low pressure ball valve - standard model

KHNVS – Low pressure ball valve - heavy duty model

Type of connection

Rp

G

Thread size

Materials

Housing, control spindle

3 = stainless steel (1.4401)

Ball

3 = stainless steel (1.4401)

Ball seals

3 = PTFE

Seals

3 = PTFE

Handle

18 = stainless steel handle, cranked, supplied fitted

Series

(determined by manufacturer)

Dimensions

KHNVN / KHNVS

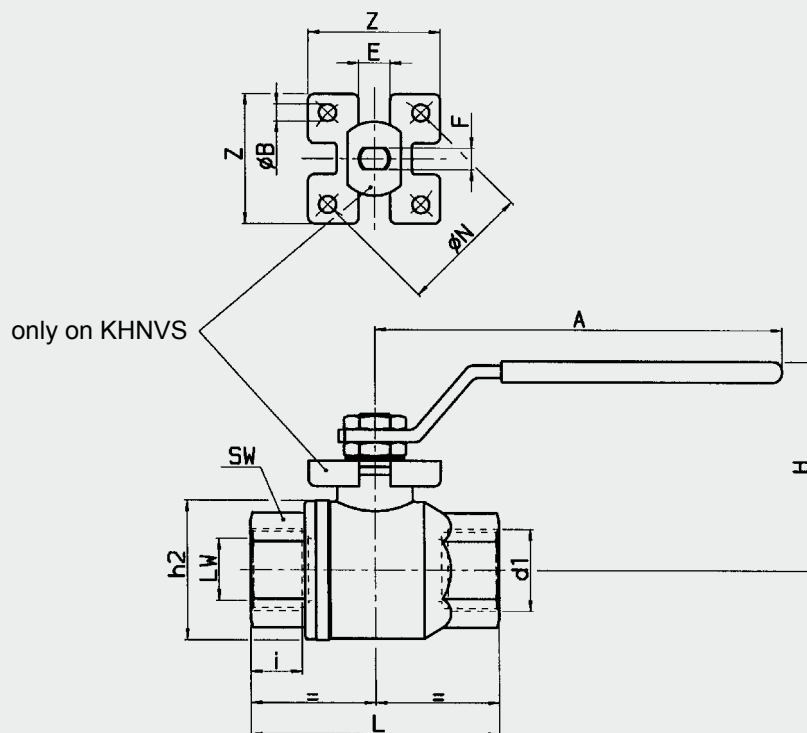

Type	d1	Nominal bore DN	ØLW Int. diam.	PN [bar]	i	L	Øh2	H	A	SW	Weight [kg]
KHNVN	G1/4	6	8	64	11	50	30	50	100	22	0.22
KHNVN	G3/8	10	10	64	11	50	30	50	100	22	0.2
KHNVN	G1/2	16	15	64	14	58	35	52	100	27	0.25
KHNVN	G3/4	20	20	64	14	65	42	57	115	32	0.45
KHNVN	G1	25	25	50	17	80	50	75	150	41	0.85
KHNVN	G1 1/4	32	32	50	18	92	63	80	150	50	1.2
KHNVN	G1 1/2	40	40	40	19	105	73	95	180	55	1.8
KHNVN	G2	50	50	40	24	125	90	100	180	70	2.7

Type	d1	Nominal bore DN	ØLW Int. diam.	PN [bar]	i	L	Øh2	H	A	SW	Weight [kg]
KHNVS	Rp1/8	04	8	140	7.4	55.5	30	50	111	22	0.25
KHNVS	Rp1/4	06	10	140	11	55.5	30	50	111	22	0.24
KHNVS	Rp3/8	10	10	140	11.4	55.5	30	50	111	22	0.22
KHNVS	Rp1/2	16	15	140	15	66	36	53	111	27	0.30
KHNVS	Rp3/4	20	20	105	16.3	79	45	68	132	32	0.50
KHNVS	Rp1	25	25	105	19.1	93	54	77	175	41	0.95
KHNVS	Rp1 1/4	32	32	64	21.4	100	64	83	175	50	1.30
KHNVS	Rp1 1/2	40	40	64	21.4	110	80	100	250	55	2.10
KHNVS	Rp2	50	50	64	25.7	131	95	108	250	70	3.30

Type	d1	ØB	F	E	ØN	Z
KHNVS	Rp1/8	–	5	8	–	–
KHNVS	Rp1/4	5.5	5	8	36F03	36
KHNVS	Rp3/8	5.5	5	8	36F03	36
KHNVS	Rp1/2	5.5	5	8	36F03	36
KHNVS	Rp3/4	5.5	7	10	42F04	42
KHNVS	Rp1	5.5	8	12	42F04	42
KHNVS	Rp11/4	5.5	8	12	42F04	42
KHNVS	Rp11/2	6.5	10	16	50F05	50
KHNVS	Rp2	8.5	10	16	50F05	50

Technical specifications

Type of connection:	Whitworth female thread to ISO 228 (G) Whitworth female thread to DIN 2999 (Rp)
Mounting position:	Optional
Ambient temperature:	-20 °C to + 160 °C
Nominal pressure:	up to PN 140 bar
Operating media:	Mineral oil to DIN 51524 Part 1 + 2, Gaseous media, compressed air, water Other media on request
Temperature of operating media:	-20 °C to + 160 °C
Accessories:	All ball valves can be supplied with the following options: Actuator Limit switch Lock

NOTE

The information in this brochure relates to the operating conditions and applications described.

For applications or operating conditions not described, please contact the relevant technical department.

Subject to technical modifications.

HYDAC Accessories GmbH
Hirschbachstr. 2
66280 Sulzbach/Saar
Tel.: +49 (0)6897 - 509-1001
Fax: +49 (0)6897 - 509-1009
Internet: www.hydac.com
E-Mail: info@hydac.com





Weld-Type Low Pressure Ball Valves KHM3S

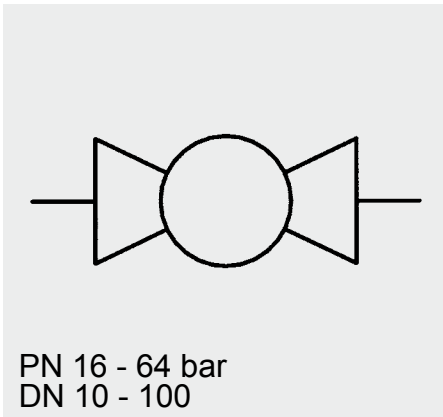

Model code
(also order example)

KHM3S 20 1333 16 X

Description

KHM3S = Three-part weld-type low pressure ball valve

Nominal bore

Materials

Housing, butt weld, spindle

- 1 = steel
- 3 = stainless steel

Ball

- 3 = stainless steel

Ball seals

- 3 = PTFE

Seals

- 3 = PTFE

Handle

- 16 = steel bolt-on handle, cranked, supplied fitted
- 18 = stainless steel bolt-on handle, cranked, supplied fitted DN 10 - 50

Series

(determined by manufacturer)

Dimensions

KHM3S

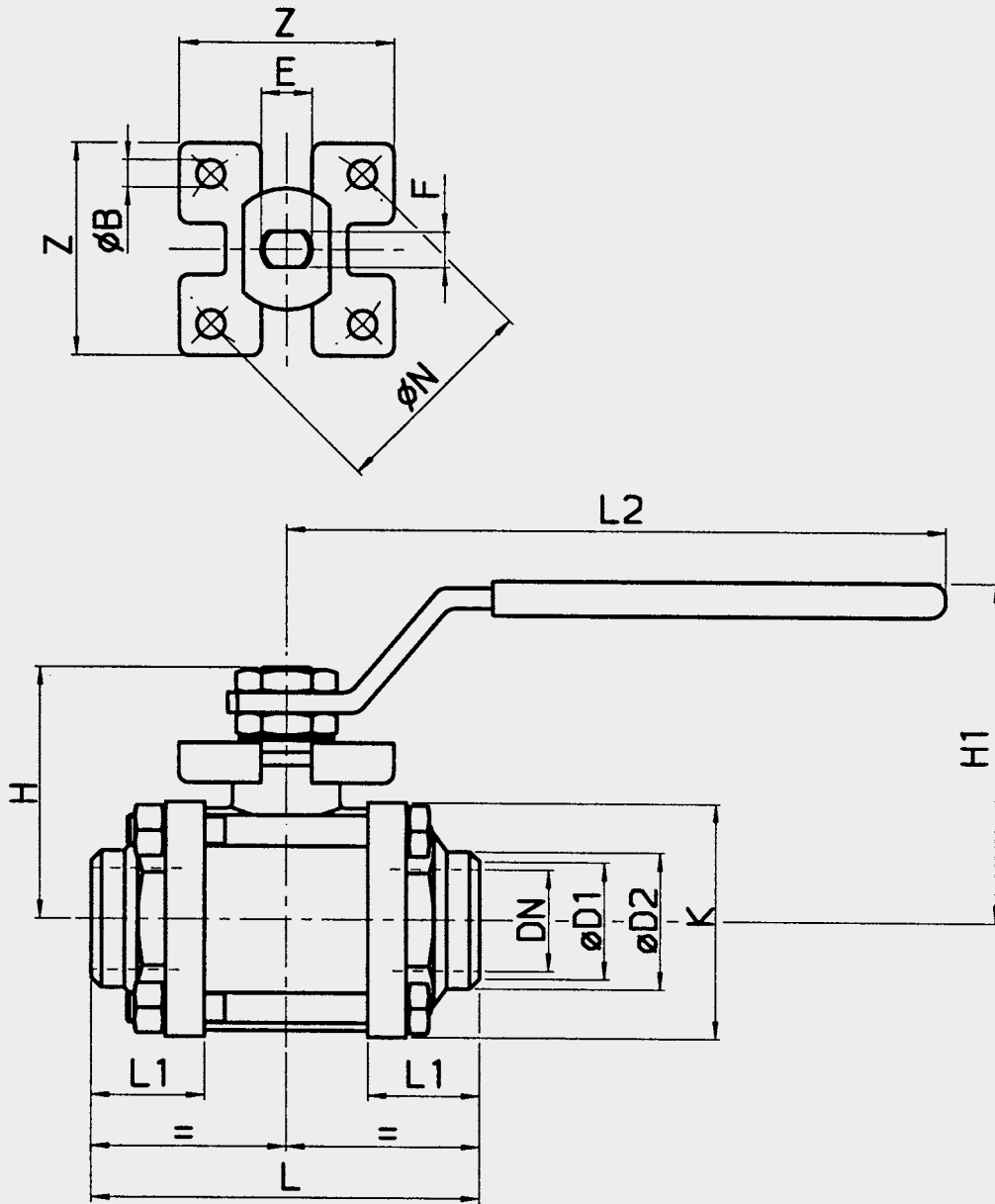

Type / Steel 1333	DN	D1	D2	H	H1	L	L1	L2
KHM3S - 10	10	12.48	17.1	35	64	65	20.5	110
KHM3S - 15	15	15.76	21.3	47	64	65	20.5	131
KHM3S - 20	20	20.96	26.7	51	68	76	22.5	131
KHM3S - 25	25	26.64	33.4	60	78	92	27	174
KHM3S - 32	32	35.08	42.2	64	83	106.5	30	174
KHM3S - 40	40	40.94	48.3	79	99.5	116	31	250
KHM3S - 50	50	52.48	60.3	86	107	136	36	250
KHM3S - 65	65	62.68	73	103	126.5	153.5	38.5	321
KHM3S - 80	80	77.92	88.9	114	137.5	180	43	321
KHM3S - 100	100	102.26	114.3	137	156.5	217	50	381

Type / Steel 1333	K	Z	B	N	F	E	Weight (kg)	PN (bar)
KHM3S - 10	38	–	–	–	7	10	0.45	64
KHM3S - 15	38	–	–	–	7	10	0.40	64
KHM3S - 20	46.5	–	–	–	7	10	0.60	40
KHM3S - 25	58	–	–	–	8	12	1.10	40
KHM3S - 32	66.5	–	–	–	8	12	1.53	25
KHM3S - 40	76	–	–	–	10	16	2.10	25
KHM3S - 50	90	50	–	–	10	16	3.20	25
KHM3S - 65	134	65	M 8	70 F07	14	20	8.30	16
KHM3S - 80	161	65	M 8	70 F07	14	20	13.40	16
KHM3S -100	190	92	M10	102 F10	18	24	22.20	16

Type / Stainless steel 3333	DN	D1	D2	H	H1	L	L1	L2
KHM3S - 10	10	13.6	17.2	35	50	55	17	110.5
KHM3S - 15	15	18	21.4	47	64	65	20.5	131.5
KHM3S - 20	20	23	27	51.5	68	76	22.5	131.5
KHM3S - 25	25	28	34	60	78	92	27	174.5
KHM3S - 32	32	35	42	64.5	83	106.5	30	174.5
KHM3S - 40	40	43	49	78	100	116	31	250.5
KHM3S - 50	50	54	60	85	107	136	36	250.5
KHM3S - 65	65	69	77	103	126.5	153.5	38.5	321.5
KHM3S - 80	80	84	90	114	137.5	180	43	321.5
KHM3S -100	100	104	116	137	156.5	217	50	381.5

Type / Stainless steel 3333	K	Z	B	N	F	E	Weight (kg)	PN (bar)
KHM3S - 10	33	–	–	–	5	8	0.28	64
KHM3S - 15	38	36	6	36 F03	7	10	0.40	64
KHM3S - 20	46.5	42	5.5	42 F04	7	10	0.60	40
KHM3S - 25	58	42	5.5	42 F04	8	12	1.10	40
KHM3S - 32	66.5	42	5.5	42 F04	8	12	1.50	25
KHM3S - 40	76	50	6.5	50 F05	10	16	2.10	25
KHM3S - 50	90	50	6.5	50 F05	10	16	3.20	25
KHM3S - 65	134	65	M 8	70 F07	14	20	8.10	16
KHM3S - 80	161	65	M 8	70 F07	14	20	12.80	16
KHM3S -100	190	92	M10	102 F10	18	24	21.50	16

Technical specifications

Type of connection:	butt weld
Mounting position:	Optional
Ambient temperature:	-20 °C to + 160 °C
Nominal pressure:	up to PN 64 bar
Operating fluids:	Mineral oil to DIN 51524 Part 1 + 2, gaseous media, compressed air, water other media on request
Temperature of operating fluid:	-20 °C to + 160 °C

Spare parts:	Seal kits available on request
Accessories:	All ball valves can be supplied with the following options: Actuator Limit controls Lock

NOTE

The information in this brochure relates to the operating conditions and applications described.

For applications or operating conditions not described, please contact the relevant technical department.

Subject to technical modifications.

HYDAC Accessories GmbH
Hirschbachstr. 2
66280 Sulzbach/Saar
Tel.: +49 (0)6897 - 509-1001
Fax: +49 (0)6897 - 509-1009
Internet: www.hydac.com
E-Mail: info@hydac.com

